

Raised brick accents the lofty arched porch that leads into a high-ceilinged entry. The rear wall of the vaulted great room is richly glassed, while a large window bay brightens the dining room. An angled eating bar separates the dining room from a kitchen where counters and cabinets span two long walls. For more details, log onto [www.Home-Plan-Weekly.com](http://www.Home-Plan-Weekly.com), or call 1-800-634-0123.

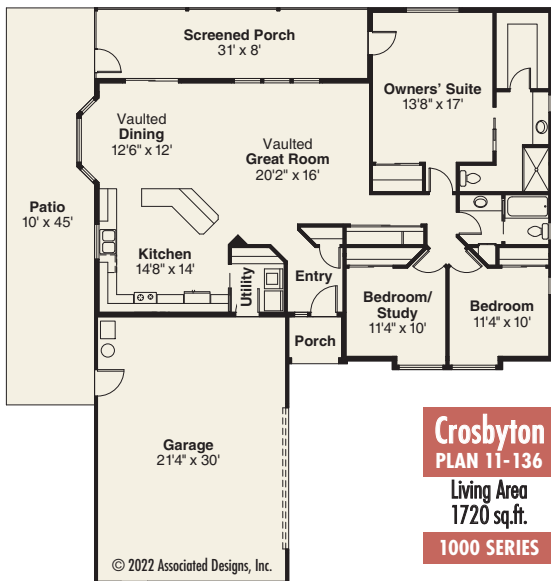

**Crosbyton**  
**PLAN 11-136**

**Living Area**  
**1720 sq.ft.**

**1000 SERIES**